

# GRIT Dust Bin Sensor

The **GRIT Dust Bin Sensor** monitors the debris level in your dust bin using an infrared LED with an adjustable detection range of up to 450mm (~18 inches). When debris reaches the set distance, an orange alert light activates and the LED on the sensor and the GRIT device flickers red – letting you know it's time to empty the bin.

The sensor features an ABS housing with an acrylic lens and includes a 6-foot cord, while the orange alert light includes a 16-foot cord for flexible placement near your dust collector. The Dust Bin Sensor is part of the GRIT ecosystem and requires a GRIT Hub to operate.



1. Alert light with 16ft cord (can be mounted with magnetic back or screws)
2. GRIT Dust Bin Sensor device
3. iR adjustable debris sensor with 6ft cord
4. 12v 2a power supply with 3ft cord

# Installation and Configuration

The instructions to install and configure your Dust Bin Sensor within the GRIT App are listed below.



## **Step 1:**

Drill a hole ~3/4" in diameter in your dust bin's lid. The hole should be placed between the outer perimeter of the canister and the outer perimeter of the hose going into the canister.



## **Step 2:**

Remove the bottom nut from the bin debris sensor and place the sensor through the hole.



**Step 3:**

Replace and tighten the nut against the lid. A note of caution, make sure the sensor does not project too low to prevent damage to it when the lid is removed.



**Step 4:**

Adhere the device to your dust collector using the provided VHB tape after cleaning the area.



**Step 5:**

Plug the provided 12v 2a power supply into the Dust Bin Sensor device, then into a 120v outlet.



**Step 6:**

Mount the alert light in a visible location. It can be mounted magnetically or with the provided mounting hardware for maximum shop visibility.



**Step 7:**

Plug the red terminal attached to the alert light into the red terminal at the top of the Dust Bin Sensor device.

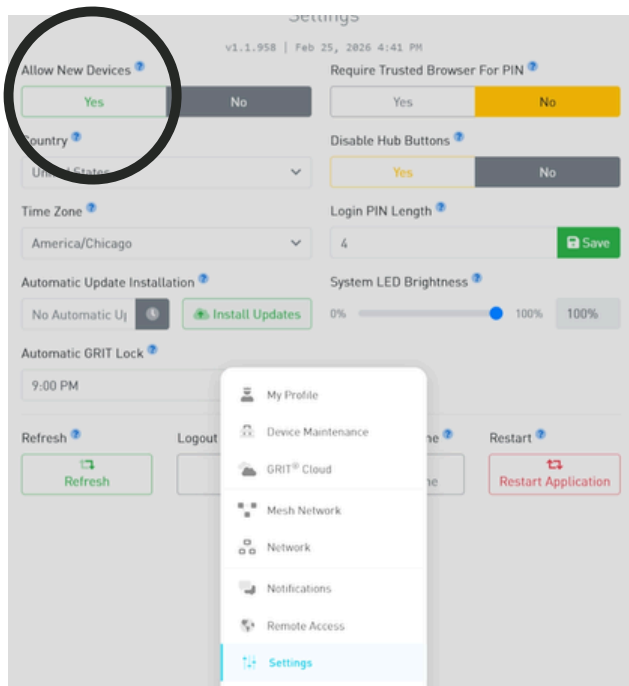

**Step 8:**

With the device installed, Bind the Dust Bin Sensor to the Hub.

Admin-->Settings-->Allow New Devices set to 'Yes'

or

Press the center, blue Bind button on the front of the Hub

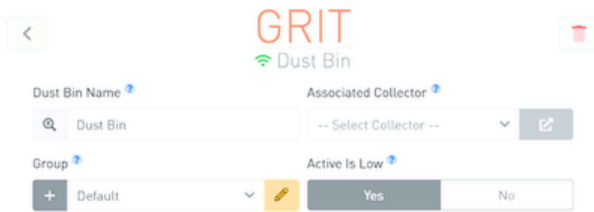

**Step 9:**

Enter the configuration screen for the dust bin sensor in the GRIT App.

Devices-->Dust Bin--> \*select specific dust bin sensor if more than one\*

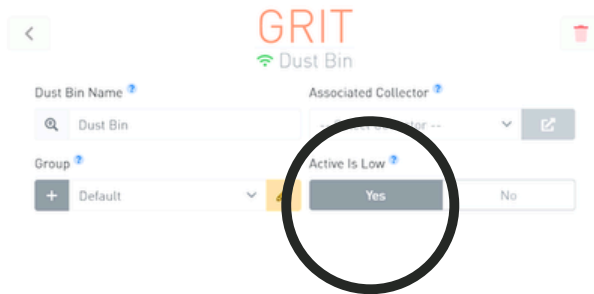

**Step 10:**

Select 'Yes' for 'Active is Low' setting.

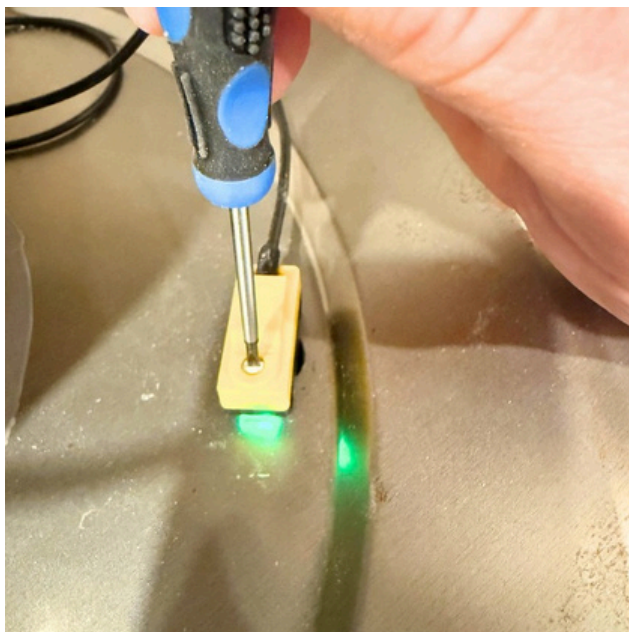

**Step 11:**

The sensor mounted through the lid of the dust bin can be adjusted to detect any preset fill level (up to 450mm). The amount of open space between the sensor and the fill level can be changed using the small screw located on top of the sensor.

# Configuration

Devices-->Dust Bin--> \*select specific dust bin sensor to configure\*

The screenshot shows the configuration page for a Dust Bin in the GRIT system. The page title is "GRIT Dust Bin". There are four numbered callouts: 1. "Dust Bin Name" field with the value "Dust Bin". 2. "Group" dropdown menu with the value "Default". 3. "Associated Collector" dropdown menu with the value "-- Select Collector --". 4. "Active Is Low" radio button group with "Yes" selected. A navigation bar at the bottom contains icons for Home, Assets, Devices, GRIT Track, Reports, and Admin.

1. Editable name field
2. Editable device grouping
3. Select the associated dust collector
4. The 'Active is Low' setting will always be set to 'Yes'